

5/2/2024		STATE	
Date: _____		District: _____	
CLASS: <u>TRAIL - PATTERN #3</u>			
HIGH SCHOOL: _____		ATHLETE #: _____	
#	ELEMENT JUDGED:	COMMENTS:	Score
1.	Be ready at start cone. Walk over bridges and poles		
2.	Jog/trot from poles to gap		
3.	Sidepass right to barrel, pick up grooming brush, sidepass left to mailbox. Put grooming brush into mail box, sidepass right to gap		
4.	Jog/trot over poles and into box, 360° left turn		
5.	Walk out of box, halt, settle for 5 seconds		
6.	Lope/canter right lead over poles, balanced halt		
7.	630° left haunch turn		
8.	Position and back trough 'L'		
9.	Open gate, go through, close. Right hand push		
10.	Overall Horsemanship		
Judge's Signature: _____			
Expectations: <ul style="list-style-type: none"> Horsemanship knowledge in displaying fundamentals is important. Accuracy, smoothness, and acceptance of obstacles should be points of training. Rythym throughout course is important. Exhibitor should not pet or unnecessarily touch horse while on course. Athlete and equine should create a working team. Movement through and over obstacles should be crisp while allowing the equine to negotiate each step. Leads should be accurate and backing should be precise, but not too slow. Haunch turns, pivots, lateral movements and backing should be smooth with continual movement. Refusals will deduct points. After 2 unsuccessful attempts, riders will be asked to move on. No steps between bridges Judges will be looking for a "finished" equine/athlete combination in this event. 			

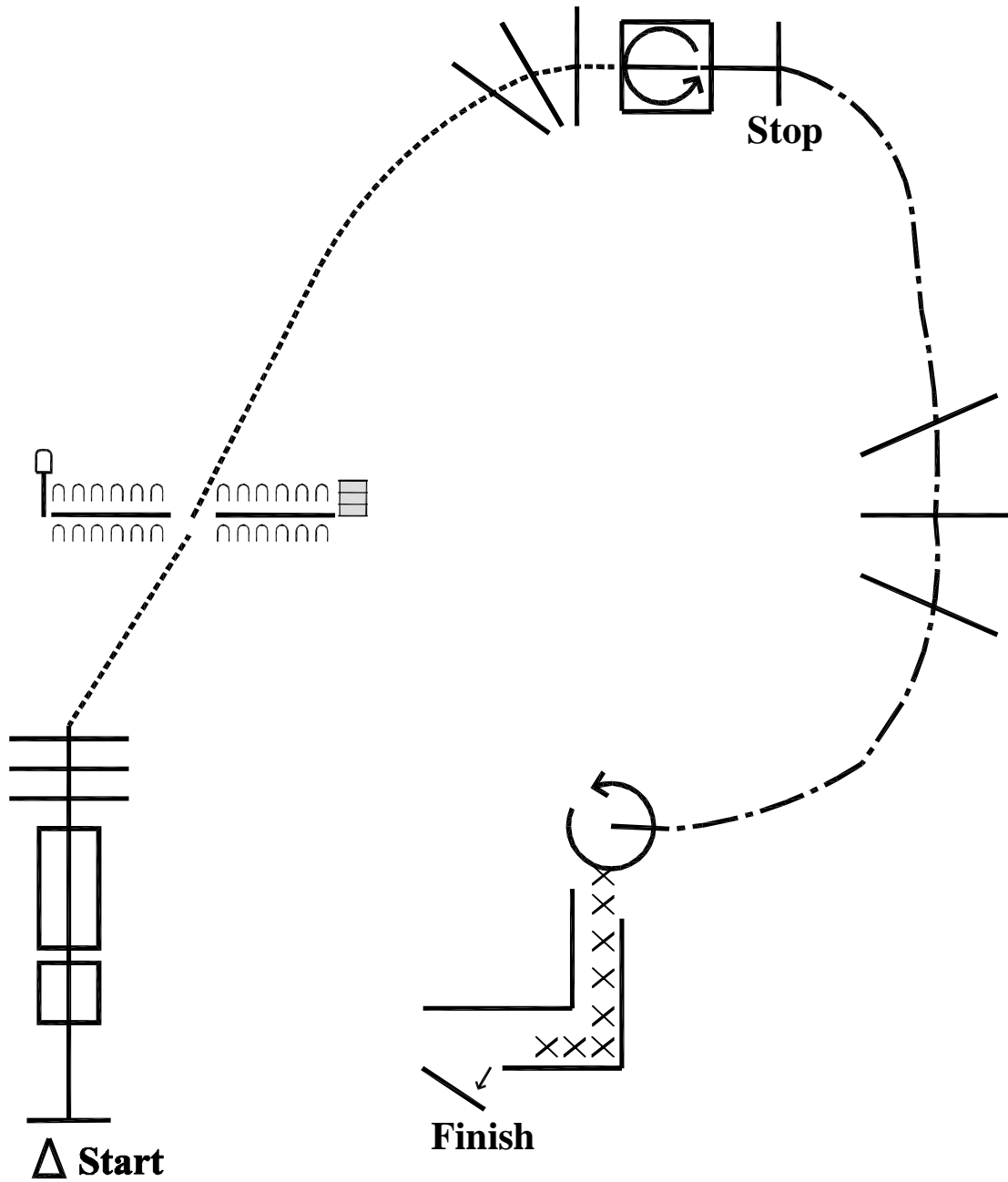

**OHSET
STATE**
 Pattern #3
 Trail (All Disciplines)
 #3.16.20.24 Revised 5-2-2024

Legend :	
Walk	————
Jog/Trot	-----
Lope	- . - . - .
Back	xxxxxx
Sidepass	uuuuuu
Start Cone	Δ

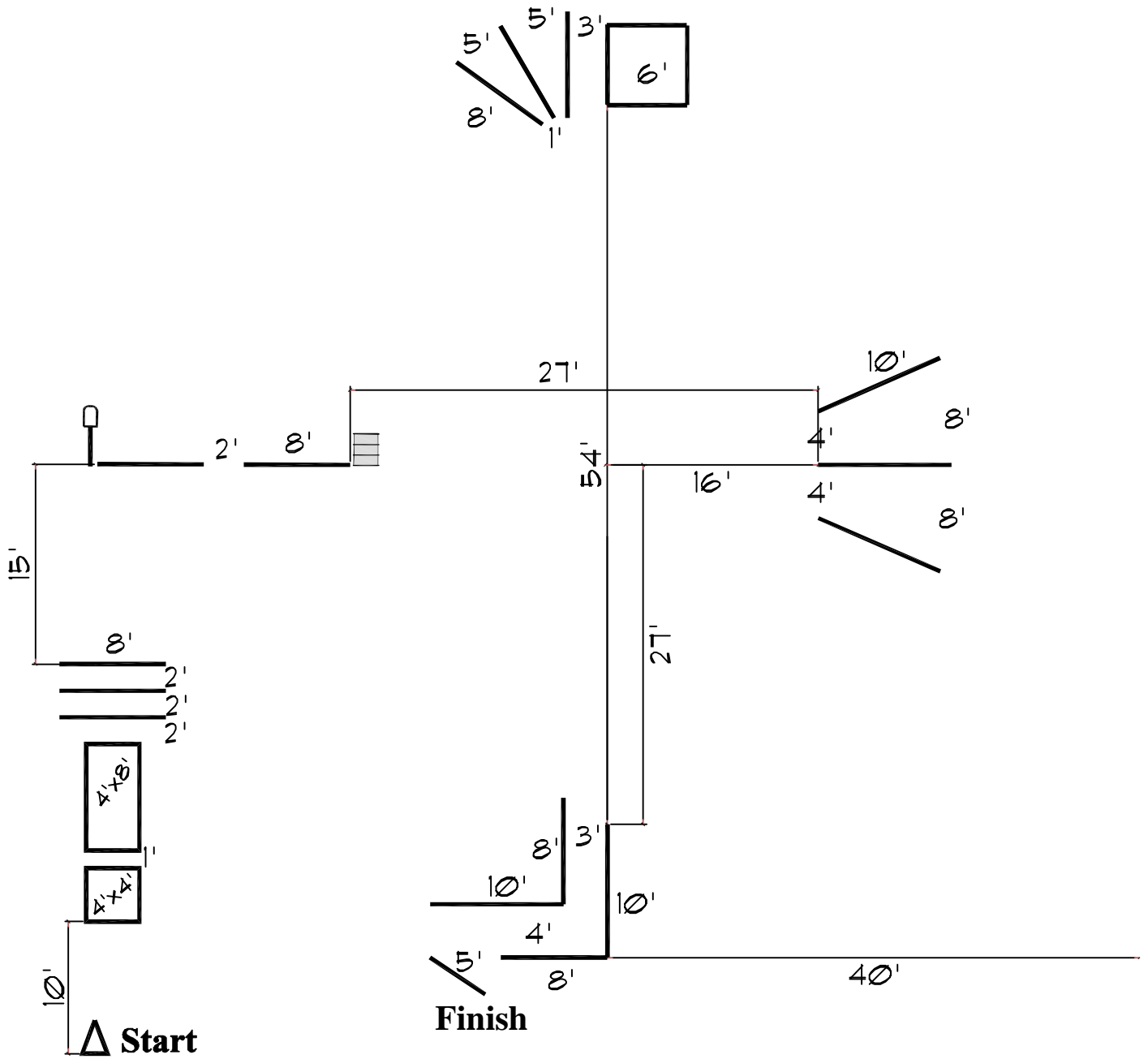

**OHSET
STATE**
Pattern #3
Trail (All Disciplines)
#3.16.20.24 Revised 7-29-20

- | Equipment Needed: |
|--|
| (1) Bridge (min 4'x6') |
| (1) Bridge 4'x4' |
| (5) 10' poles |
| (10) 8' poles |
| (4) 6' poles |
| (1) barrel |
| (1) mail box approximately 42" tall |
| Brush (to fit into mailbox) |
| (1) rope gate (approx. 5') |
| (1) standard cone (about 12"-18" tall) |